

For Work Surfaces that have M6 metal inserts*:

Parts required**:

- A. 1 Work Surface (*not shown*)
- B. 1 Float Table Base and Release Paddle
- C. (12) 16 mm (0.63 in.) M6 Machine Screws
- D. (4) 35 mm (1.38 in.) M5 Long Machine Screws
- E. Crank Handle and Holder (*Holder not shown*)

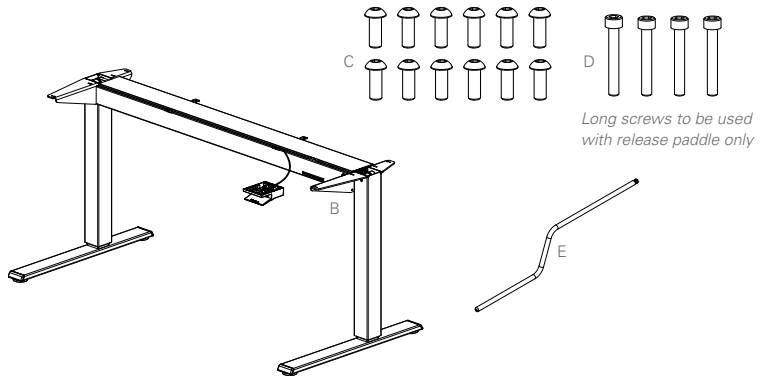

Assembly Steps

Place the Work Surface face down on a soft surface to avoid scratching it.

Place the Base upside down onto the underside of the Work Surface.

Ensure that all metal inserts line up with the holes in the Base frame brackets. Using (12) M6 Screws, fasten the Work Surface to the Base frame.

Line up the Release Paddle with corresponding holes on the underside of the Work Surface. Using (4) M5 Long Machine Screws, fasten the Release Paddle to the Work Surface.

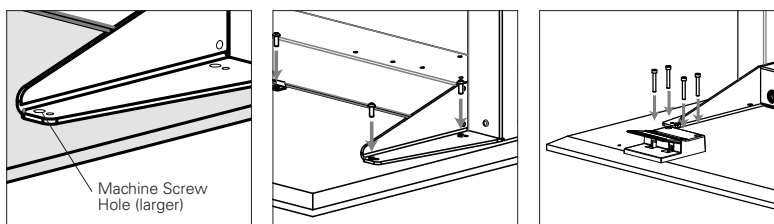
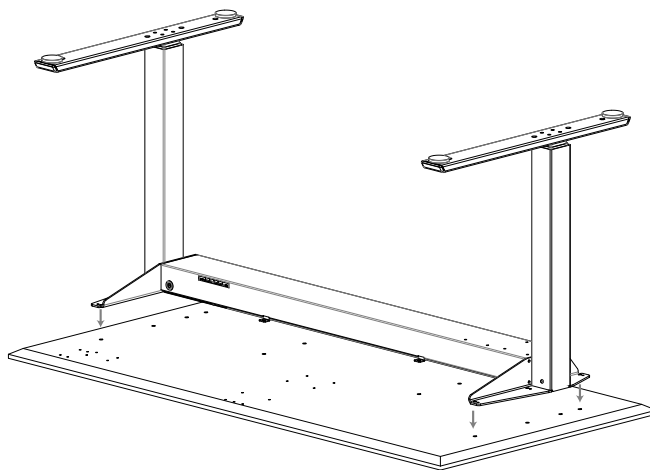

* Such as Work Surfaces manufactured for Humanscale

**You will receive two sets of screws — one machine with screws, and one with wooden screws. Please only use the screws listed in the "parts required" for your applicable instructions.

For Work Surfaces that **do not** have M6 metal inserts***:

Parts included**:

- A. 1 Float Table Base and Release Paddle
- B. (12) 3/4" Wood Screws
- C. (4) 1 1/2" Wood Screws
- D. Crank Handle and Holder
(holder not shown)

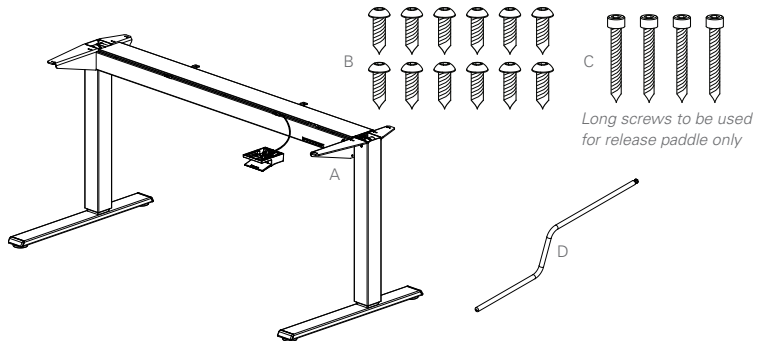

Assembly Steps

Place the Work Surface face down on a soft surface to avoid scratching it.

Place the Base upside down onto the underside of the Work Surface.

Center the Base such that there is equal distance from the edge of the Work Surface on either side.

For tables that have 30" deep surfaces, measure and mark 16.5" from the front edge of the Work Surface to the top channel on the Base top frame.

For tables that have 24" deep surfaces, measure and mark 13.5" from the front edge of the Work Surface to the top channel on the Base top frame.

Holding the Base in place according to your markings, **install (12) 3/4" Wood Screws** in the bracket holes on the Base frame.

Install the Release Paddle 1/2" from the front edge of the Work Surface on its underside and 2.25" from the inside edge of the leg bracket. Using (4) 1 1/2" Wood Screws, fasten the Release Paddle to the Work Surface.

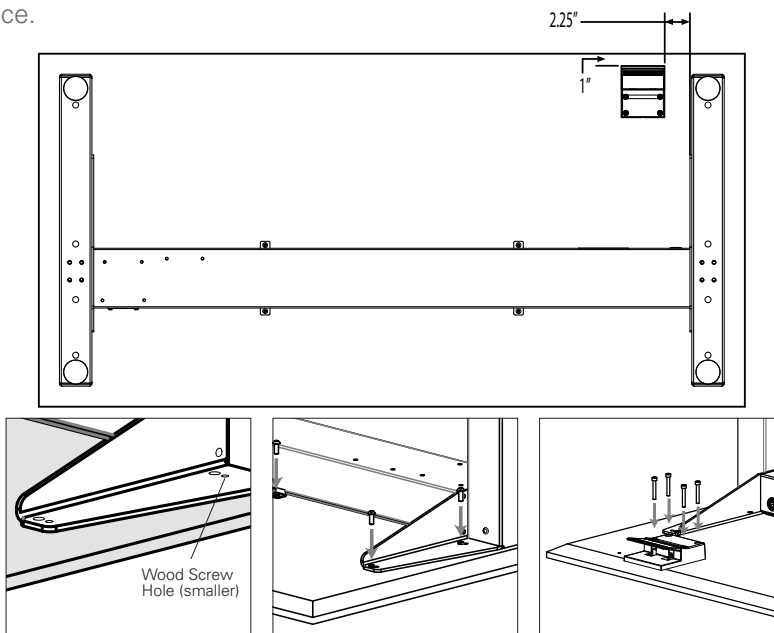

** You will receive two sets of screws — one machine with screws, and one with wooden screws. Please only use the screws listed in the "parts included" for your applicable instructions.

*** Work surface must be at least 3/4" thick.