

# Assembly & Installation Instructions: Sierra HX 2-Leg Work Center

SEHX30-48-FXX-XX-X

**Workrite**  
ergonomics®

## Parts Included

**A** Leg  
Qty: 2

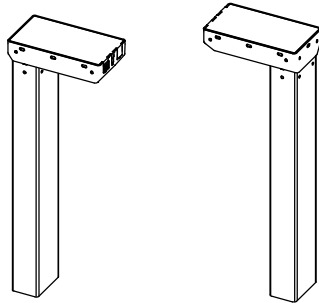

**B** Short Bracket  
Qty: 4

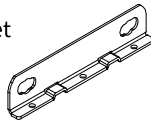

**C** Left End Bracket  
Qty: 1

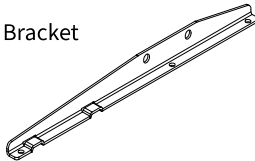

**D** Right End Bracket  
Qty: 1

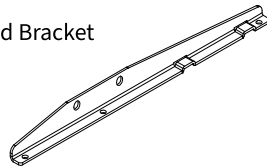

**E** 4 mm Allen Wrench  
Qty: 1



**F** #M6 × 14 mm Flat Head  
Cap Screw  
Qty: 4



**G** #12 × ¾" Pan Head Screw  
Qty: 20



**H** M8 × 18 mm Flat  
Head Cap Screw  
Qty: 4

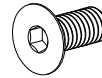

**I** 5 mm Allen Wrench  
Qty: 1



**J** Foot Glide  
Qty: 4



**K** Control Box  
Qty: 1

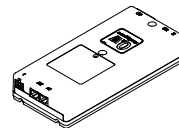

**L** #12 × 2" Flat Head Screw  
Qty: 2



**M** Cable Spool  
Qty: 2



**N** #8 × ⅝" Pan Head Screw  
Qty: 7



**O** ¾" Cable Loops  
Qty: 5



**P** Cable Clips  
Qty: 4

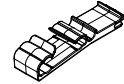

**Q** Motor Cable,  
1 meter  
Qty: 2

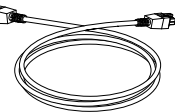

**R** Power Cord  
Qty: 1

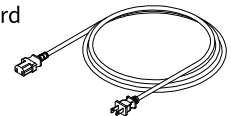

**S** Feet  
Qty: 2

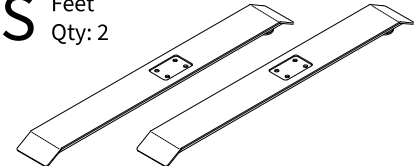

**T** Standard, Bluetooth, or  
Programmable Switch  
Qty: 1

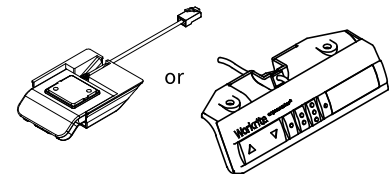

## Worksurface Required, Sold Separately:

		Width	Depth
24" Feet	Rectangle	34-48"	23-24"
	Rectangle	34-48"	29-30"
	Equal Corner	40-48" × 40-48"	23-24"
		46-48" × 46-48"	29-30"
	120 Degree	34-36" × 34-36"	29-30"
		40-42" × 40-42"	29-30"
		46-48" × 46-48"	29-30"

## Tools Required:

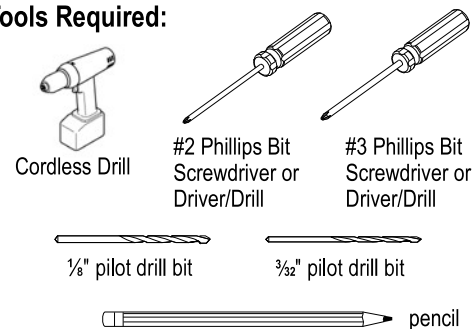

## SAVE THESE INSTRUCTIONS

**⚠ WARNING:** Maximum equipment loading of table assembly in addition to specified top is as follows:

- Maximum Top Weight: 80 lb (36.4 kg)
- Maximum Equipment Load: 225 lb (102.2 kg)

Loading should be evenly distributed over table surfaces.

**V = 120 VAC, 60 Hz / 4 A maximum**

**FLAMMABILITY:** All worksurfaces used must meet UL 962 flammability requirements

- Flame Spread Rating maximum 200
- Smoke Developed Index maximum 450

**WORKSURFACE MATERIAL:** This frameset is designed to accommodate worksurfaces made from Industrial Particle Board with nominal thickness of 1.125". If the worksurface is not appropriate or not mounted correctly to the table, it could cause the complete table to be unstable, it may collapse, and for an adjustable table, the electrical components may fail.

**Intended for indoor use only.**

**For commercial use only.**

### IMPORTANT SAFETY INSTRUCTIONS:

When using an electrical furnishing, basic precautions should always be followed, including the following:  
Read all instructions before using this Sierra HX Work Center.

**DANGER:** To reduce the risk of electric shock, always unplug this Sierra HX Work Center from the electrical outlet before cleaning or servicing.

**⚠ WARNING:** To reduce the risk of burns, fire, electric shock, or injury to persons:

1. Unplug from outlet before putting on or taking off parts.
2. Close supervision is necessary when this furnishing is used by, or near children, invalids, or disabled persons.
3. Use this Sierra HX Work Center only for its intended use as described in these instructions, do not use attachments not recommended by the manufacturer.
4. Never operate this Sierra HX Work Center if it has a damaged cord or plug, is not working properly, has been dropped or damaged, or dropped into water. Return the furnishing to a service center for examination and repair.
5. Keep the cord away from heated surfaces.
6. Do not operate outdoors.
7. Do not operate where aerosol (spray) products are being used or where oxygen is being administered.
8. Use only SJT Type 18/2 AWG Cord.
9. To disconnect, remove plug from outlet.
10. Do not exceed maximum load recommendations.

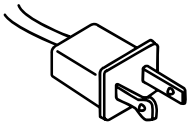

**Polarized Plug**  
Figure A

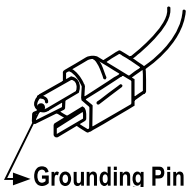

**Grounding Pin**  
Figure B

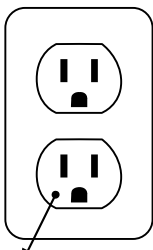

**Grounded Outlet**  
Figure C

**Polarized Plug Instructions** (Only applicable to products having a polarized plug power cord):

Some products include a polarized plug—see **Figure A** (One A/C plug blade wider than the other)—to reduce the risk of electrical shock. A polarized plug only fits a polarized power outlet one way. If the polarized plug does not fit properly into the electrical outlet turn the power plug over to see if it then fits properly and fully into the outlet. If the plug does still does not fit the outlet, contact a certified electrician to install the correct matching polarized electrical outlet.

**Caution:** Never modify the power cord plug in any way

**Double-Insulated Products Instructions:**

Some products are double-insulated. No means of grounding is required or provided on a double-insulated product; nor is a means for grounding to be added to the product. The plug in a double insulated system is shown in **Figure A**. Double-insulated products are indicated with markings of "double-insulated" or the "double box symbol"  or both.

**Grounding Instructions** (For grounded electric products only):

Products with grounded power cords are for use on a nominal 120 V circuit and has a grounded plug as shown in **Figure B**. Make sure the product is connected to an electrical outlet having the same configuration as the plug shown in **Figure C**.

**Caution:** Never modify, remove, or use adaptors that eliminate the ground connections from the grounded power cord

**A/C Power:**

Products sold in North America and other regions are 120 V A/C as marked on the power supply/control box of the furnishing and are to be used on a normal 120 V A/C circuit. Always follow the instructions above for power connection using grounded or double insulated power cords as supplied.

- Only use power cord(s) supplied with your electric product
- Never modify, alter, use an adaptor, or change the electrical system of this product in any way.

**Warning:** Doing so may cause risk of electrical shock or fire

*Illustration Disclaimer—Power Plug and Receptacle Images:*

*In some cases, the images in this instruction may not match the power cord supplied with your electrical furnishing based on your region. Plug type, blade size, and shape may change.*

## 1 Attach Brackets to Legs

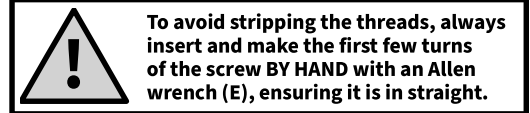

- 1.1 Place the Short Brackets (B) onto the mount pins on the front and rear of the Right and Left Leg as shown.
- 1.2 Slide Short Bracket toward the end of the leg onto the shouldered pins.
- 1.3 On the Left Leg attach the Left End Bracket (C) using #M6 × 14 mm Flat Head Cap Screws (F) and tighten securely with the 4 mm Allen Wrench (E).
- 1.4 On the Right Leg attach the Right End Bracket (D) using #M6 × 14 mm Flat Head Cap Screws (F) and tighten securely.

**Note:** The Right End Bracket will be on your left and vice versa when the assembly is seen upside down.

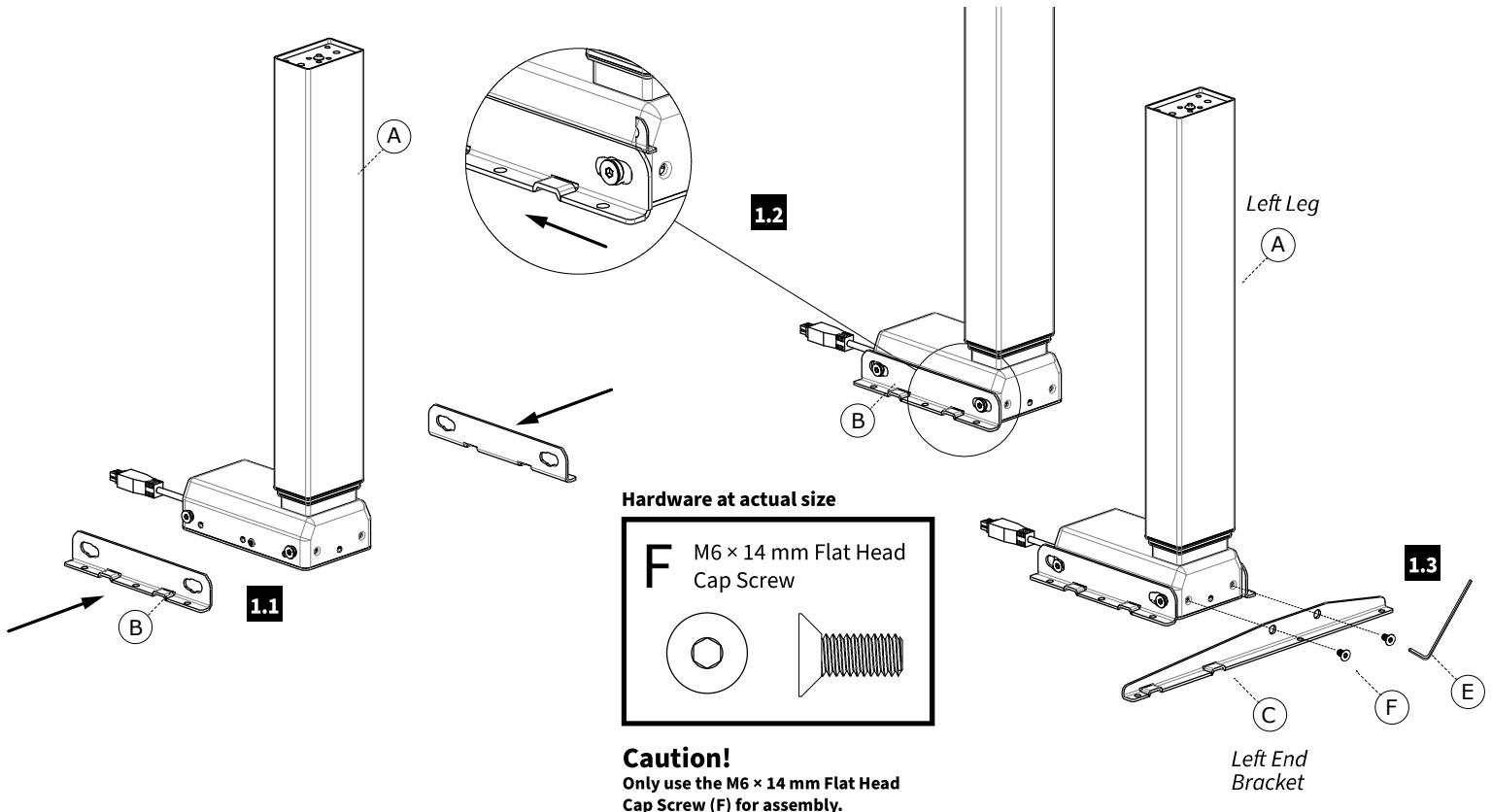

## 2 Attach Feet & Install Foot Glides

- 2.1 Attach one (1) Foot (S) to each leg using two (2) #M8 × 18 mm Flat Head Cap Screws (H) and tighten securely with the 5 mm Allen Wrench (I).
- 2.2 Install two (2) Glides (J) into each foot.

**Note:** When installing 29" deep feet the longer front end of the foot faces forward to match the longer front end of the top bracket.

**Be sure the longer end of the foot goes towards the front of the work center.**

**Hardware at actual size**

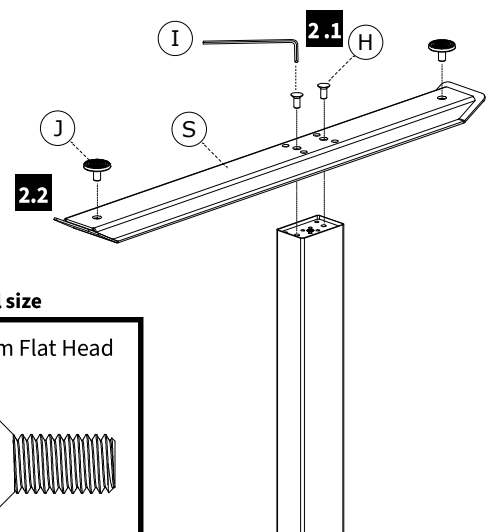
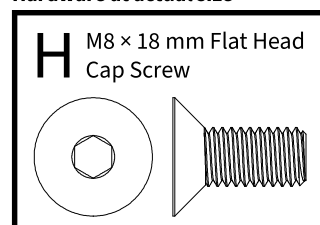

### 3 Attach Legs to Worksurface—For Workrite Pre-Drilled Tops

**Note:** For 2-Leg Corner and 120° Top Mounting Instructions, go to: [www.workriteergo.com/instructions](http://www.workriteergo.com/instructions)

**3.1** Align the left and right leg assembly over the pre-drilled mounting locations in the top.

**3.2** Install one (1) #12 × ¾" Pan Head Screw (G) into the four corner locations shown.

**Note:** If using an electric drill to install the #12 screws, set the drill to the lowest torque setting to avoid overtightening and stripping the screws into the top.

Hardware at actual size

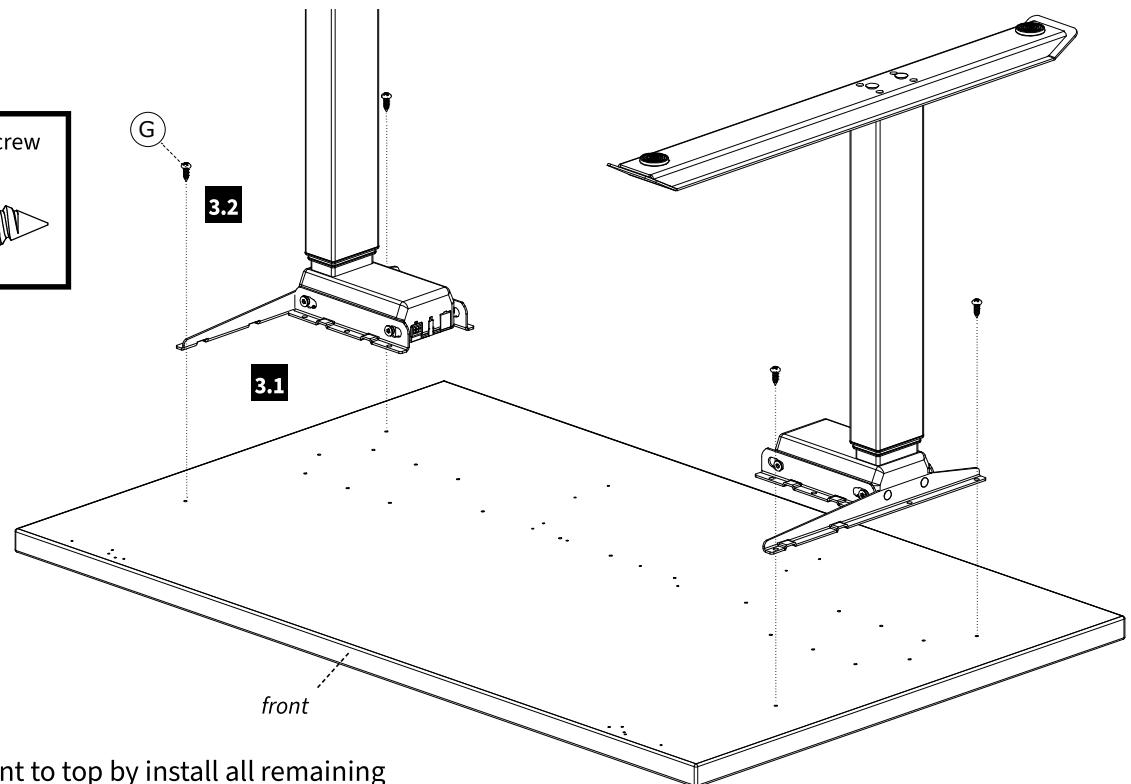
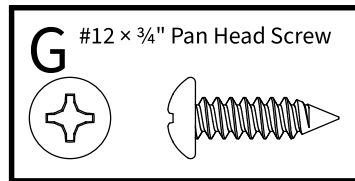

**3.3** Complete leg attachment to top by install all remaining #12 × ¾" Pan Head Screws (G) and tighten securely.

**Note:** For 2-Leg Equal Corner and 120° Worksurface Mounting Instructions, go to: [www.workriteergo.com/instructions](http://www.workriteergo.com/instructions)

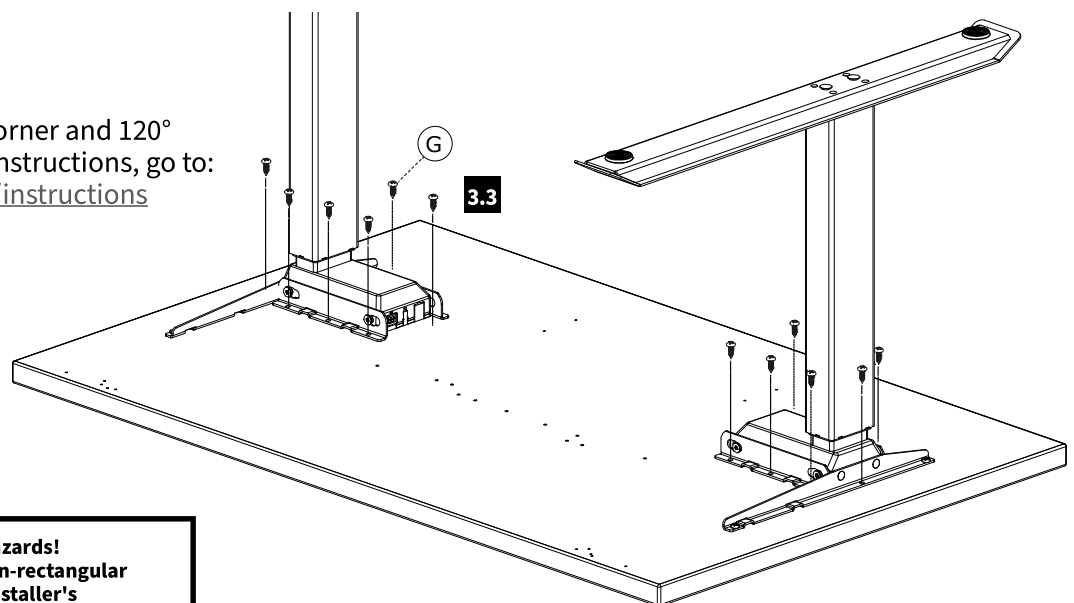

**Note: Avoid trip or tip hazards!**  
For uniquely shaped, non-rectangular worksurfaces, it is the installer's responsibility to position the worksurface to minimize extended overhangs and position feet fully under the worksurface.

### 3a

## Attach Legs to Worksurface—For Tops without Pre-Drilled Holes

**3.1a** Position leg assemblies  $3\frac{5}{8}$ " in from the sides and  $6\frac{1}{2}$ " in from the rear of the worksurface, making sure the legs are parallel with the back edge of the worksurface.

**3.2a** Use a  $\frac{1}{8}$ " drill bit to drill pilot holes at the four corner locations.

*We recommend you mark your drill bit so you don't drill more than  $\frac{3}{4}$ " deep into your worksurface top.*

**Be careful not to drill through your worksurface!**

**3.3a** Install one (1) #12  $\times \frac{3}{4}$ " Pan Head Screw (G) into the four corner locations shown.

**Note:** *If using an electric drill to install the #12 screws, set the drill to the lowest torque setting to avoid overtightening and stripping the screws into the top.*

**3.4a** Drill all remaining pilot holes for the brackets into the top and install all remaining #12  $\times \frac{3}{4}$ " Pan Head Screws (G).



**Note: Avoid trip or tip hazards!**

For uniquely shaped, non-rectangular worksurfaces, it is the installer's responsibility to position the worksurface to minimize extended overhangs and position feet fully under the worksurface.

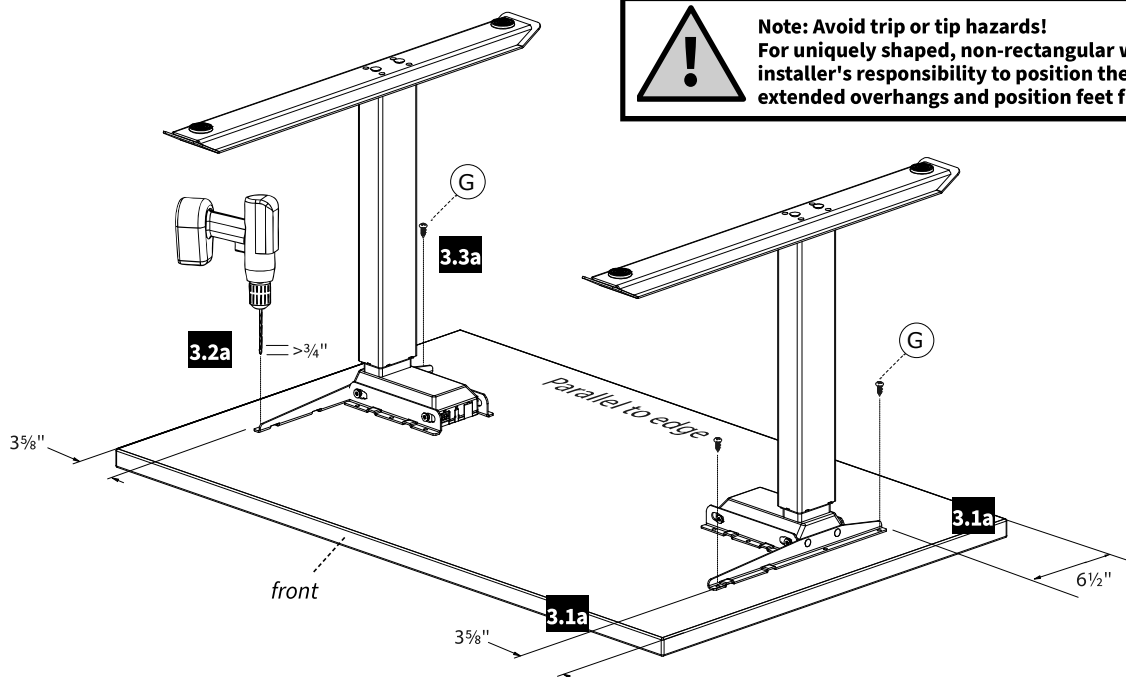

Hardware at actual size

**G**

#12  $\times \frac{3}{4}$ " Pan Head Screw

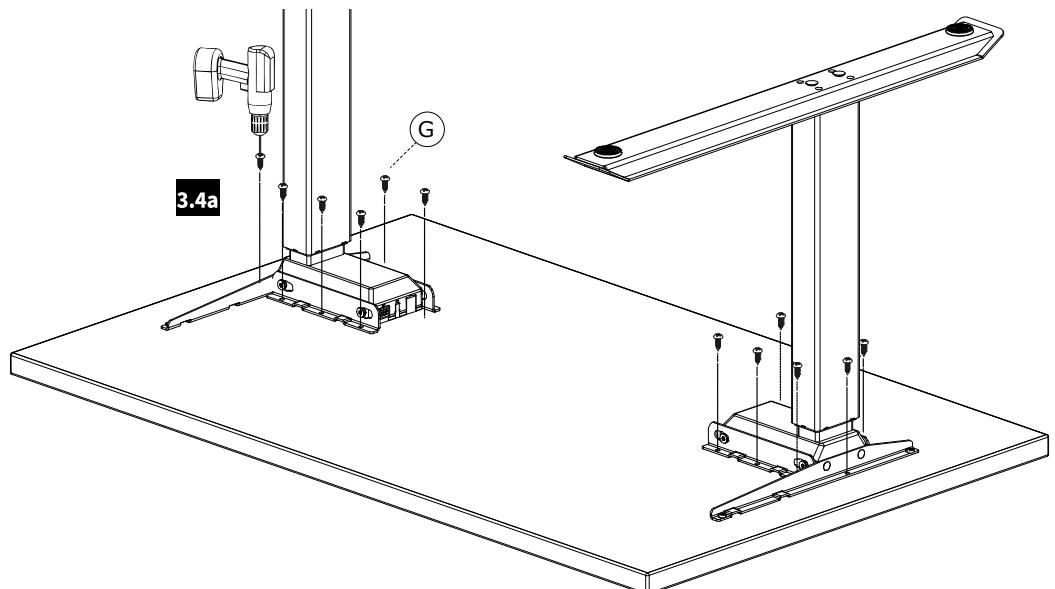
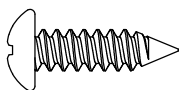

## 4 Attach Switch—For Workrite Pre-Drilled Tops

- 4.1** Place the Switch (T) over pre-drilled mounting locations as shown.
- 4.2** Attach the Switch (T) with two (2) #8 × 5/8" Pan Head Screws (N) and tighten securely.

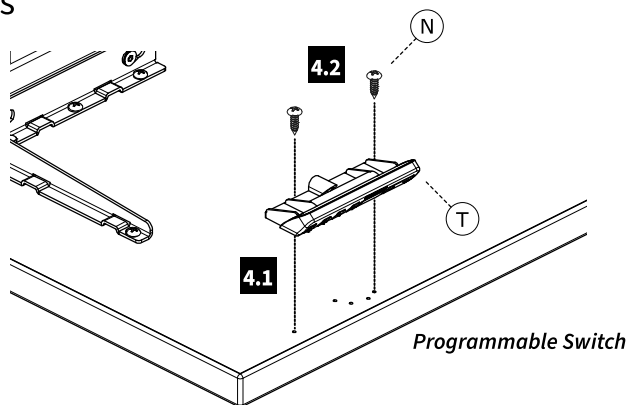

Hardware at actual size

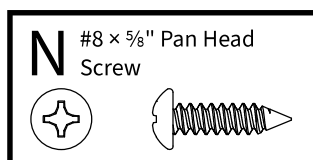

**Note:** Right hand location shown—the Switch (T) can be located on the right or left side of the table as required. The Control Box will need to be reversed in step 6 for left hand Switch mounting.

## 4a Attach Switch—For Tops without Pre-Drilled Holes

- 4.1a** Place the Switch (T) onto the top at the dimensions shown.
- 4.2a** Using your drill and a 3/32" drill bit, drill the switch mounting holes as shown.
- 4.3a** Attach the Switch (T) with two (2) #8 × 5/8" Pan Head Screws (N).

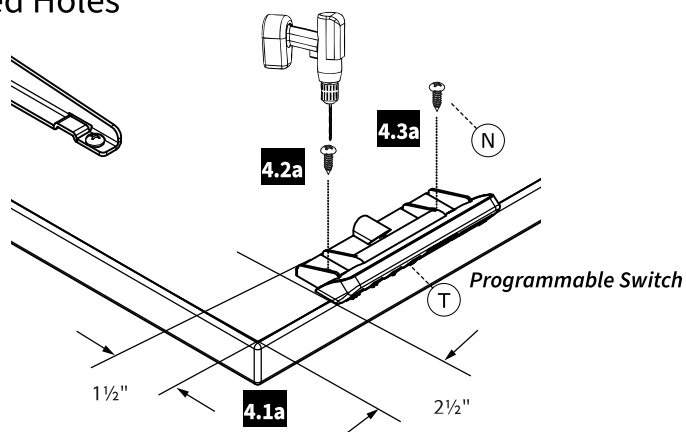

**Note:** Right hand location shown—the Switch (T) can be located on the right or left side of the table as required. The Control Box will need to be reversed in step 6 for left hand Switch mounting.

**Note:** use the screws provided with Standard & BT-Proswitch to mount the switch using the diagram below.

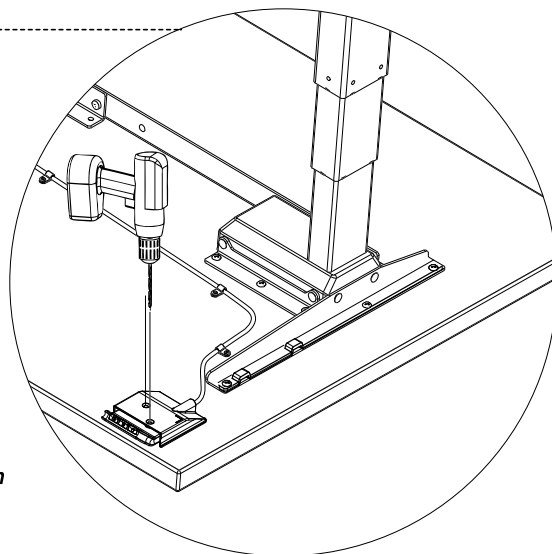
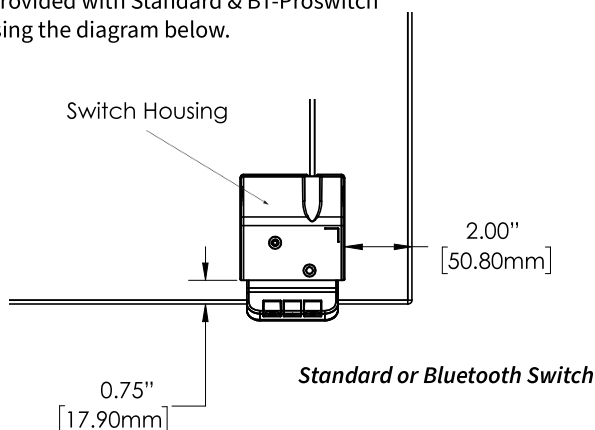

## 5 Loop Power Cord through Strain Relief on Control Box

- 5.1 Loop the Power Cord (R) through the strain relief channel on the bottom of the Control Box (K) as shown. Leave 8" of slack to route cord.
- 5.2 Plug Power Cord (R) into power outlet AC on the Control Box (K).
- 5.3 Lay the Control Box down in installation location with cables in place.

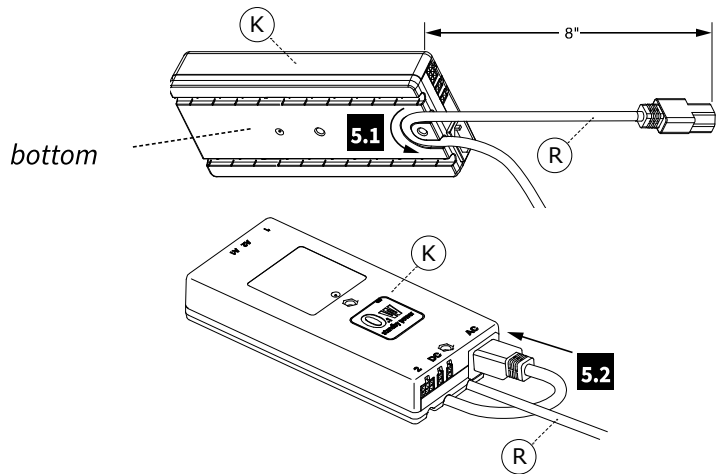

## 6 Attach Control Box—For Workrite Pre-Drilled Tops / Right-Hand Switch

**Note:** Failure to tighten the control box to the desk securely will cause false collision detection resulting in the inability to adjust height properly. If this occurs, re-tighten the control box securely to the top.

- 6.1 Place the Control Box (K) over the pre-drilled hole locations as shown with motor cable and switch cable ports facing the right leg.
- 6.2 Attach the Control Box (K) to the top with two (2) #12 × 2" Flat Head Screws (L) and tighten securely.

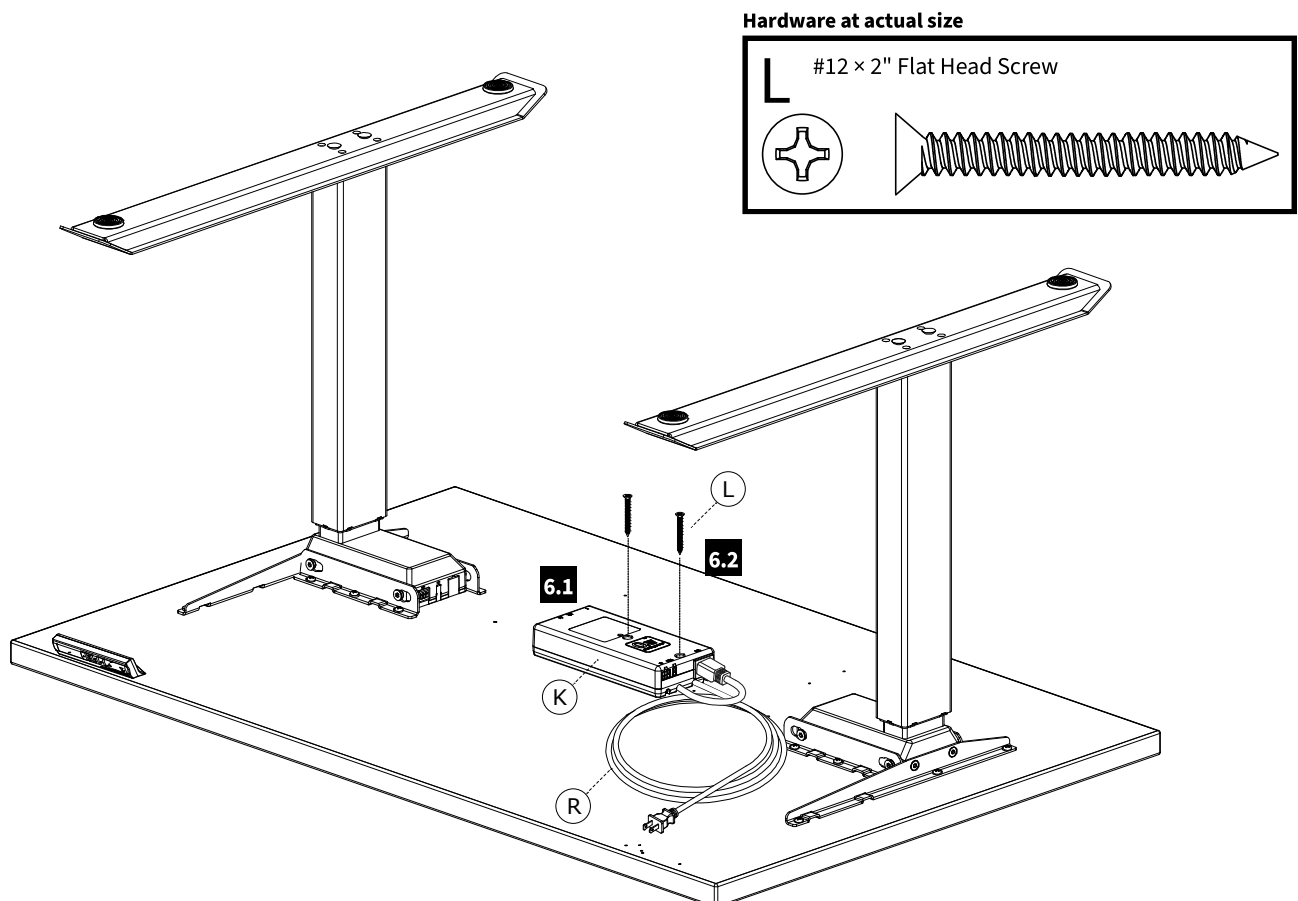

## 6a Attach Control Box—For Tops without Pre-Drilled Holes / Right-Hand Switch

- 6.1a** Place the Control Box (K) as shown with motor cable and switch cable ports facing the right leg.
- 6.2a** Using the right leg motor cable length as a guide, place the Control Box (K) as close to the left leg as possible.
- 6.3a** Using the control box as a guide, drill two pilot holes into the top using the 1/8" drill bit.

**Be careful not to drill through your worksurface!**

- 6.4a** Mount the Control Box (L) to the top with two (2) #12 × 2" Flat Head Screws (L) and tighten securely.

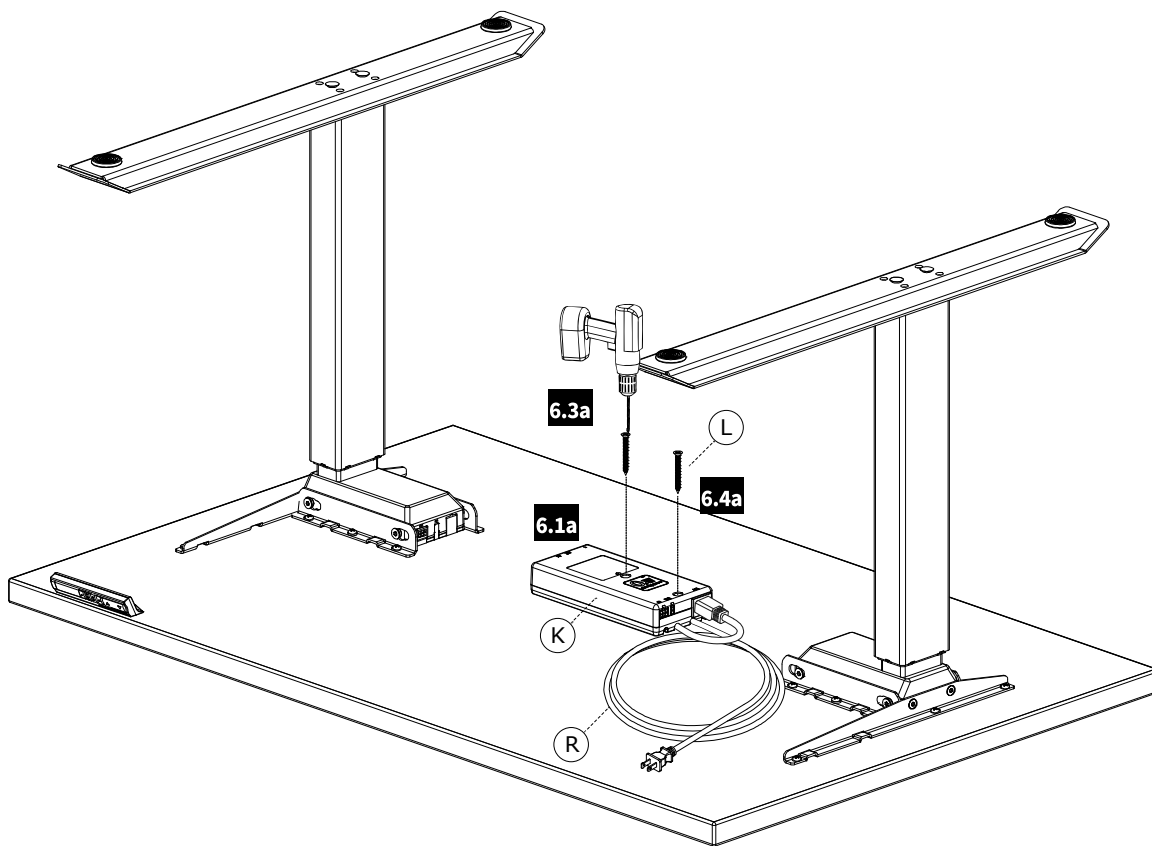

Hardware at actual size

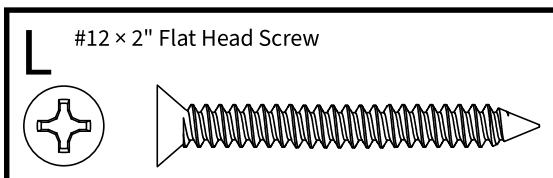



## 7 Install Motor Cables

- 7.1** Connect one Motor Cable (Q) to the left and right leg.
- 7.2** Place the Cable Spools (M) one between the right leg and the control box and one between the left leg and control box as shown.
- 7.3** Attach each Cable Spool (M) to the top with one (1) #12 × ¾" Pan Head Screw (G) and tighten securely.
- 7.3a** If your top is not predrilled—drill a ⅛" pilot hole into the top and attach each Cable Spool (M) to the top with one (1) #12 × ¾" Pan Head Screw (G) and tighten securely.

**Be careful not to drill through your worksurface!**

- 7.4** If required on wider tables secure the Motor Cables from the leg to the cable spool neatly to the top with Cable Loops (O) and one (1) #8 × ⅝" Pan Head Screw (N) per Cable Loop as required.
- 7.5** Wind the excess motor cable length around the Cable Spools (M) and then connect the Motor Cable (Q) to the Control Box (K) as shown.

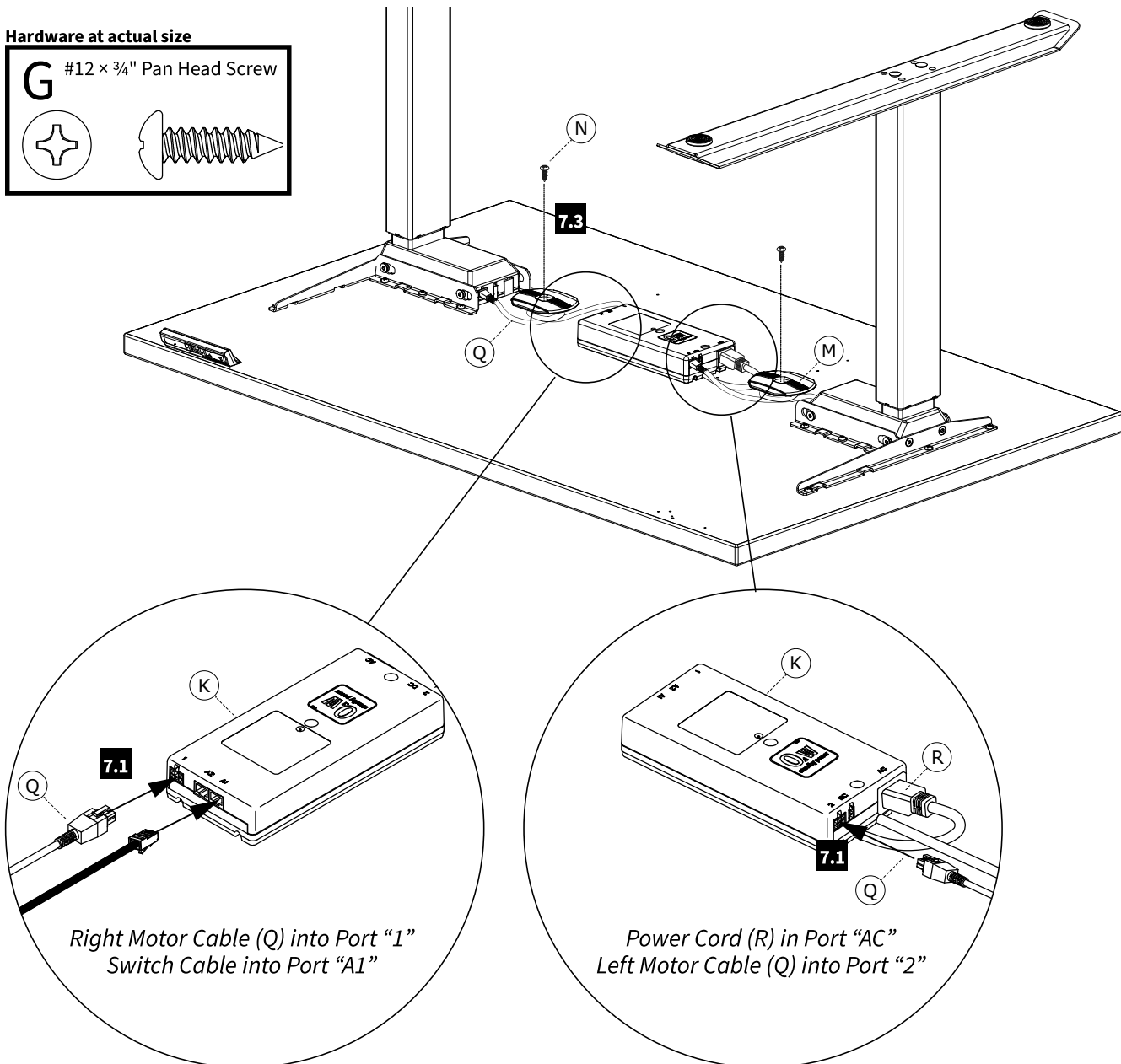

## 8 Plug in Switch Cable

- 8.1** Install 4 Cable Clips (P) into the Right End Bracket (D) and the right front Short Motor Bracket (B).
- 8.2** Route the switch cable from the switch back to the control box snapping the switch cable in the Cable Clips (P) installed in the Right End Bracket and Short Motor Bracket.
- 8.3** Wind the excess switch cable length around the Cable Spool (M) and then connect the switch cable to the Control Box (K).

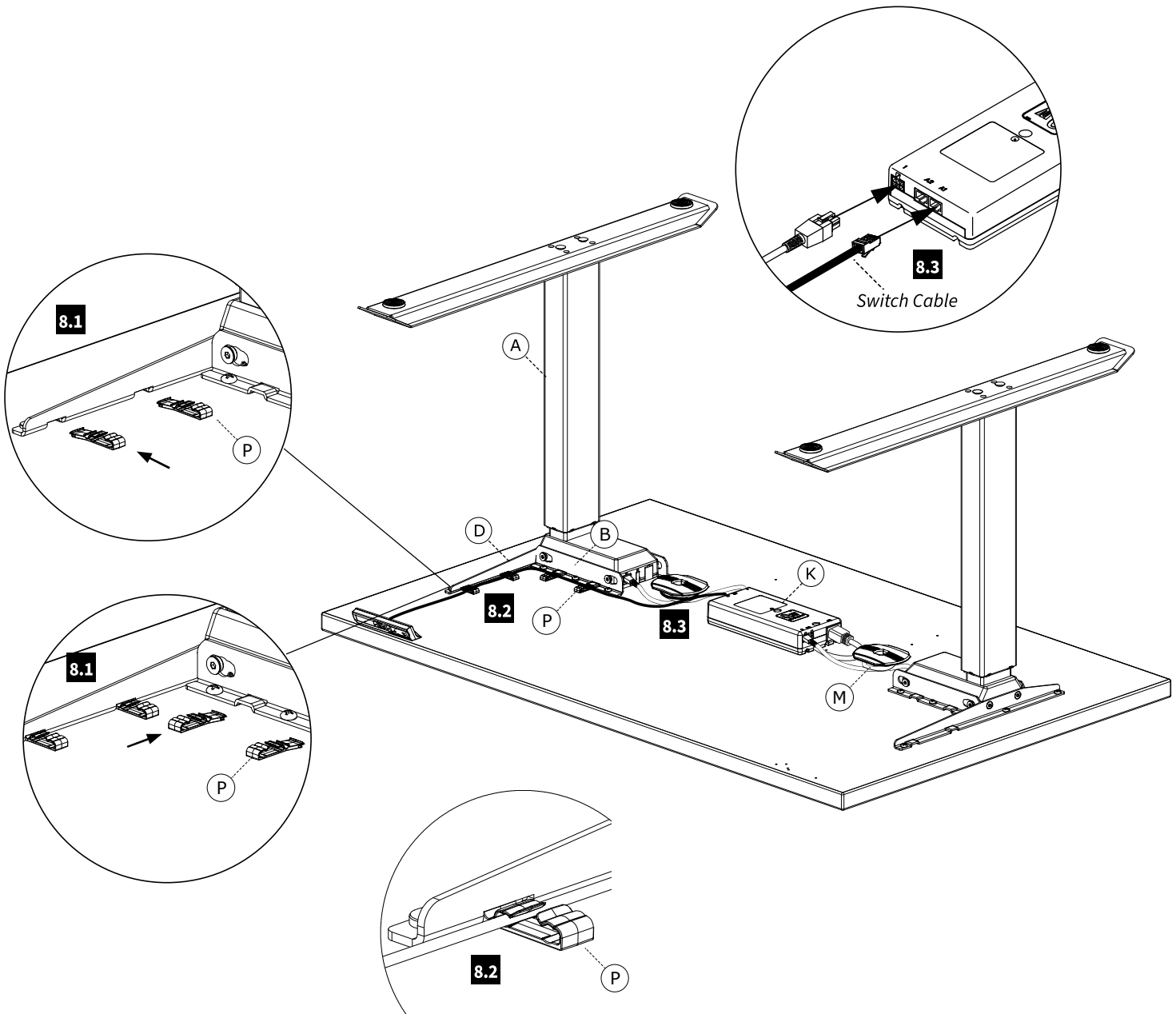

---

## 9 Put Work Center Upright and Connect Power Cord to the Power Supply

**9.1** Turn the work center over into an upright position.

**CAUTION!** Always use at least two people to flip and move work centers.

**9.2** Plug the Power Cord (R) into the power outlet.

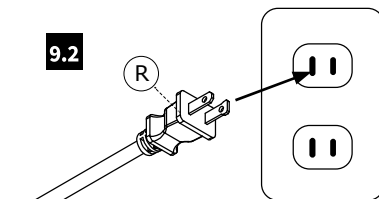
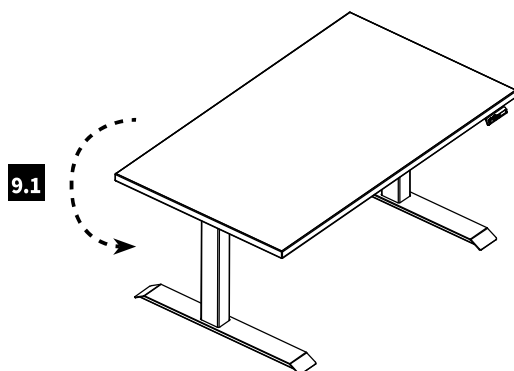

---

## 10 Adjust Feet Glides

If necessary, adjust the Foot Glides (J) on work center feet to level the worksurface. Unscrew to increase height, screw in to decrease height.

---

## 11 Initialize Legs

**Note:** After plugging in power for the first time you must initialize the base.

Press and hold the down button on the Switch (T). The reset code or E-01 will appear, and the base will make a short down and up movement and when the digital readout returns to 22.5" the initialization is complete, and the table is ready to use.

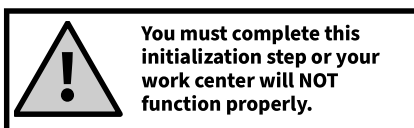

---

## ✓ Cleaning Instructions

To clean the SierraHX base, apply cleaner to a soft cloth.

Suggested cleaners: Windex or Formula 409.

*Do not use solvents and do not saturate or spray cleaners directly onto work center base.*

---

## ✓ Parts & Accessories

Visit [http://workriteergo.com/documentation/other/workrite\\_ergonomics\\_pricing\\_specification\\_guide.pdf](http://workriteergo.com/documentation/other/workrite_ergonomics_pricing_specification_guide.pdf) for replacement parts.



## Programmable Switch Settings

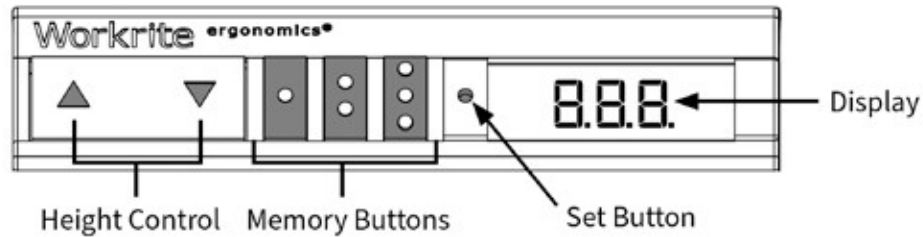

## A Set Memory Height Positions

### MEMORY BUTTON FACTORY SETTINGS

The Programmable Switch is pre-programmed from the factory at the following heights:

SEHX & FDEX	FDLX
Button 1  preset at 26" Seated work surface height for the average female.	Button 1  preset at 31"
Button 2  preset at 28" Seated work surface height for the average male.	Button 2  preset at 33"
Button 3  preset at 42" Average standing counter height.	Button 3  preset at 47"

### REPROGRAMMING MEMORY BUTTONS

All three memory buttons can be reprogrammed to your preferred height settings.

1. Use ▲ and ▼ button to move the work center to the height to be saved to memory.
2. Press and release the SET button ("5" will appear on the screen).
3. Select and press a memory button to save. The letter "5" and the number of the memory button selected will flash for 2 seconds confirming memory has been set.

Repeat this process for each additional memory button you want to reprogram.

### MOVE TO A MEMORY HEIGHT

Press and hold continuously button , , or until the work center stops at the preset height.

## B Set Custom Height Limit

### SETTING CUSTOM HEIGHT LIMITS

The custom height limit feature protects the work center from colliding with items placed above or below the worksurface such as overhanging shelves or pedestals below.

#### Set Lower Limit:

1. Move your work center to the desired lower limit (Leave a 1" minimum space between the worksurface and the object below the work center for safety).
2. Press the **SET** and ▼ buttons simultaneously for 2 seconds. The display shows L0 and the lower limit is set.

#### Set Lower Limit:

1. Move your work center to the desired upper limit (Leave a 1" minimum space between the worksurface and the object above the work center for safety).
2. Press the **SET** and ▲ buttons simultaneously for 2 seconds. The display shows H1 and the upper limit is set.

#### Set Lower Limit:



1. Press the **SET**, ▲, and ▼ buttons simultaneously for 4 seconds. The display shows CLR to indicate height limits have been removed.

---

## **C** Table "Lock Use" Feature



The lock feature disables the work center from moving.

**TO LOCK:** Press the **SET** button until **LOC** appears and flashes twice on the display (once locked **LOC** will appear on the display when any button is pushed and the work center will not operate).

**TO UNLOCK:** Press and release the memory buttons in order:  then  then  (the digital height readout will return and all buttons will return to normal operation).

---

## **D** Change from Inches to Centimeters

1. Simultaneously press and hold ,  and  buttons for 5 seconds until the display flashes repeatedly.
2. Press the **SET** button with a ballpoint pen (Do NOT use a paperclip—it may damage the electronics) to change from inches to centimeters.

To return to inches, repeat the same process.